

FHC9700

ATEX IP66 high power explosion proof floodlight 240W high pole light



FHC9700 series



Ex marking: Ex db IIC T5/T4/T3 Gb
Ex tb IIIC T95°C/T130°C/T195°C Db



Characteristics

- A full range of high conductivity material accelerate convection cooling structure, effective guarantee long-term use in high temperature environments.
- Variety of light distribution, variety of installation types, an effective solution to beautify workshop and device platform.
- It adopts imported light source, no dark spot, energy-saving is 60% more than Metal Halide Lamp.
- AC-DC wide voltage driver, power factor above 0.98.
- The rapid replacement of power without welding can be realized.
- The adjustable locking device on the bracket can tightly fix the lamp to any desired angle, making the lamp resist to harsh vibration.
- It is made using aluminum housing, all exposed fasteners adopt 304 stainless steel. Using high-tech anti-corrosion surface treatment technology, suitable for hazardous working areas.
- Windward area is only 30% of the traditional lamp, suitable for high-altitude winds area.
- Intelligent control functions can be realized.

Application

- Applicable to the gas explosion zone 1, zone 2 and zone 21, zone 22 dust explosion;
- Oil wharf, petrochemical plant, chemical plant, pharmaceutical factory and other dangerous road lighting tank.

Light distribution curve

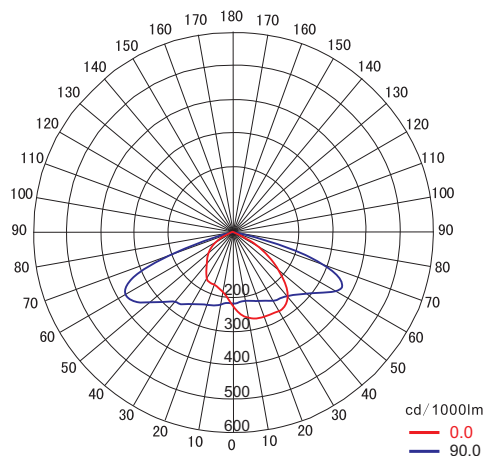

Main Specification



Item	Technical Parameters
Input voltage (V)	90~305VAC
Rated frequency	50Hz / 60Hz
Light source	LED
Life time (h)	50,000
CRI (Ra)	70 (80 optional)
CCT	5000K(3000K/4000K optional)
Cable entry	M20×1.5, M25×1.5, G3/4", NPT1/2", NPT3/4"
Dimension (mm)	300×202×332
Net weight (kg)	6.3



FHC9700

ATEX IP66 high power explosion proof floodlight 240W high pole light



Ordering Reference

Ordering reference	Rated Wattage (W)	Light output (lm)	Space height ratio	Mounting height (m)	Equivalent to
					MH
FHC9700-L60	60W	6600	1.75	6~8m	150W
FHC9700-L80	80W	8400		8~10m	175W
FHC9700-L100	100W	11000			250W
FHC9700-L120	120W	12600		10~12m	250~400W
FHC9700-L150	150W	16000			400W
FHC9700-L200	200W	22000		12~15m	400~600W



FHC9700

ATEX IP66 high power explosion proof floodlight 240W high pole light



Drawing of mounting (Dimensions in mm)

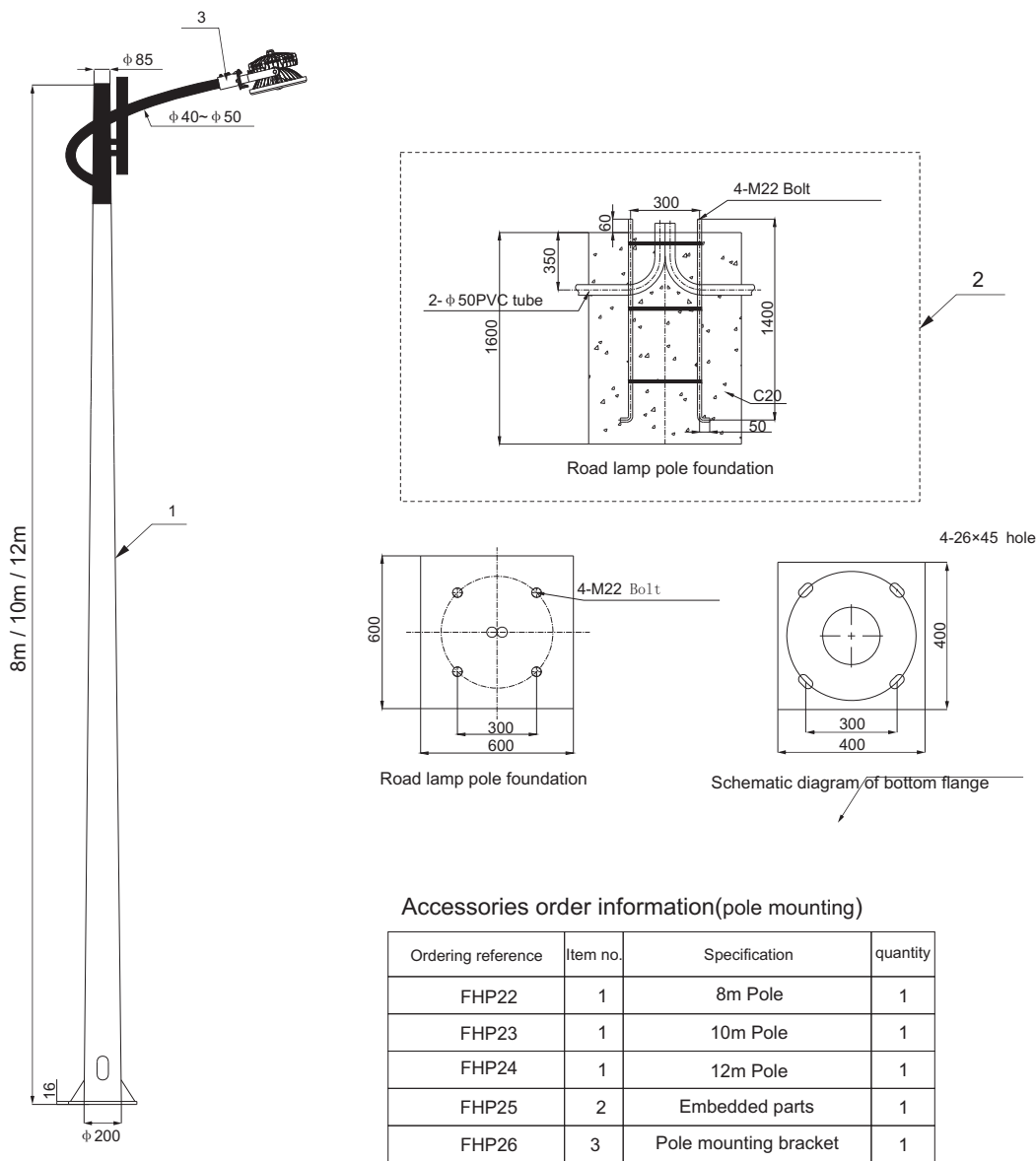

Accessories order information(pole mounting)

Ordering reference	Item no.	Specification	quantity
FHP22	1	8m Pole	1
FHP23	1	10m Pole	1
FHP24	1	12m Pole	1
FHP25	2	Embedded parts	1
FHP26	3	Pole mounting bracket	1

Single arm installation (post purchase)



www.fhsolarled.com



FH SOLAR & LED IBERICA S.L.
 Núñez Morgado 5 | 28036 Madrid
 Tel.+34 913235993 | +34 600027027
 info@fhsolarled.com
 Spain . Colombia . México

